

1447 Peachtree Street NE, Suite 850  
Atlanta, Georgia 30309  
phone: 404.873.6730

www.tsw-design.com  
location

648 Union Street E.  
Jacksonville, Florida

# "Zoning Plan" Phase I: Surface Parking

Scale: 1" = 100'-0"



Copyright. All rights reserved. Reproduction in whole or in part is prohibited. This drawing as an instrument of service is the property of the architect and may not be used in any way without the written permission of this office.

project title  
Union Terminal Site Site  
for  
Columbia Ventures

drawing information  
project number: n/a  
contact: TSW  
drawn by: TSW  
checked by: TSW  
scale: 1" = 100'  
drawing date  
03/08/2019

**LEGEND:**

- EXISTING BUILDING
- OFF-SITE RECREATION AND OPEN SPACE TO SUPPORT RESIDENTIAL USE

**VICINITY MAP**  
NOT TO SCALE

The vicinity map shows the site location at the intersection of Union Street and Palmetto Street, bounded by Oakley Street to the south and another street to the east. The site is shaded in grey.

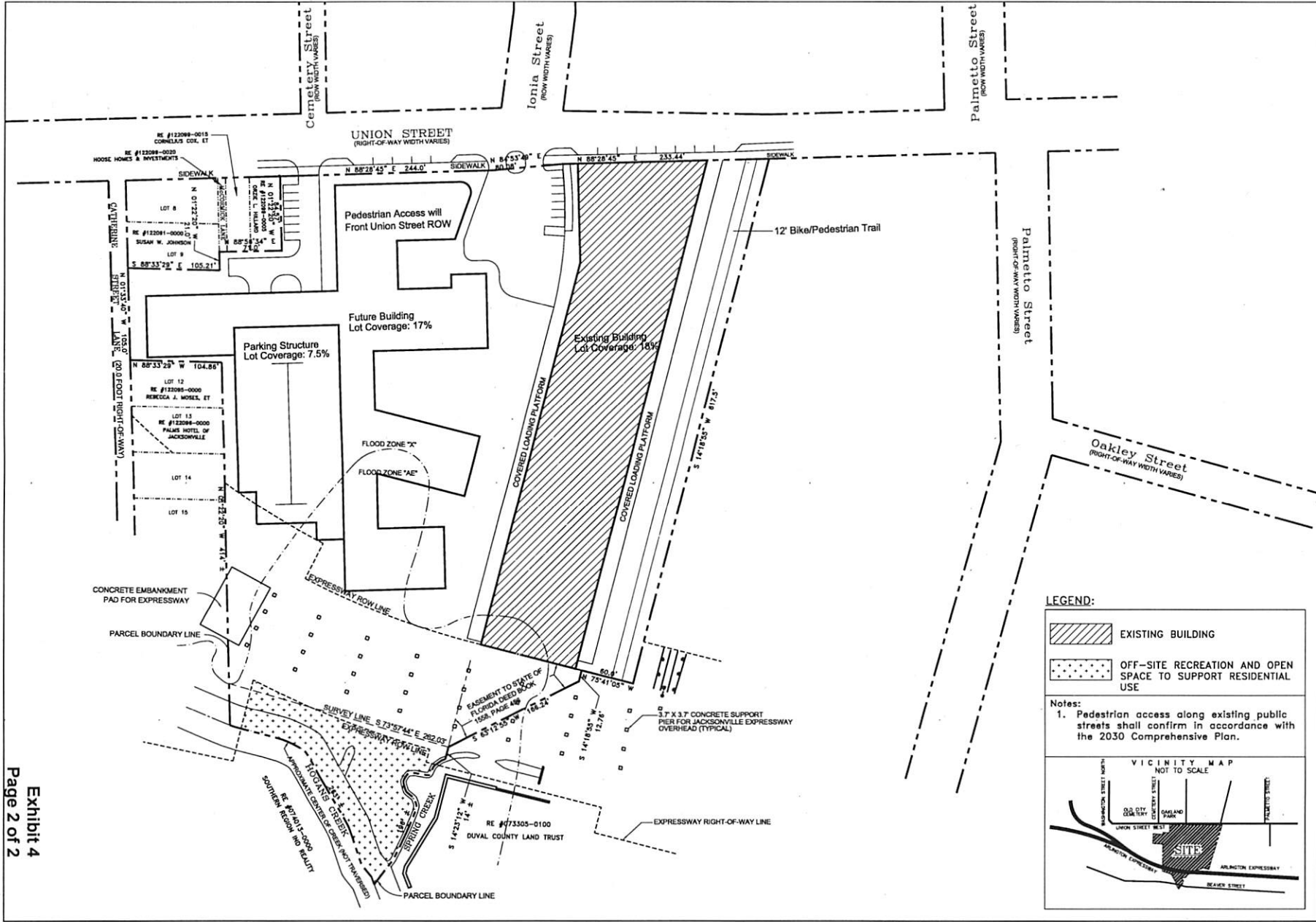

1447 Peachtree Street NE,  
Suite 850  
Atlanta, Georgia 30309  
phone: 404.873.6730

www.tsw-design.com  
location

648 Union Street E.  
Jacksonville, Florida

# "Zoning Plan" Phase II: Proposed Building

Scale: 1" = 100'-0"



Copyright. All rights reserved.  
Reproduction in whole or in part is  
prohibited. This drawing is an  
instrument of service in the  
property of the architect and may  
not be used in any way without  
the written permission of this  
office.

project title  
**Union Terminal Site  
Site**

for  
Columbia Ventures

drawing information  
project number: n/a  
contact: TSW  
drawn by: TSW  
checked by: TSW  
scale: 1" = 100'

drawing date  
03/08/2019

**LEGEND:**

- EXISTING BUILDING
- OFF-SITE RECREATION AND OPEN SPACE TO SUPPORT RESIDENTIAL USE

**Notes:**

1. Pedestrian access along existing public streets shall confirm in accordance with the 2030 Comprehensive Plan.

**VICINITY MAP NOT TO SCALE**